

APPLICATION:

UNKNOWN. IMI CANNOT GUARANTEE RESULTS. THE STACK SHOULD BE 50MM SHORTER THAN THE FANNER.

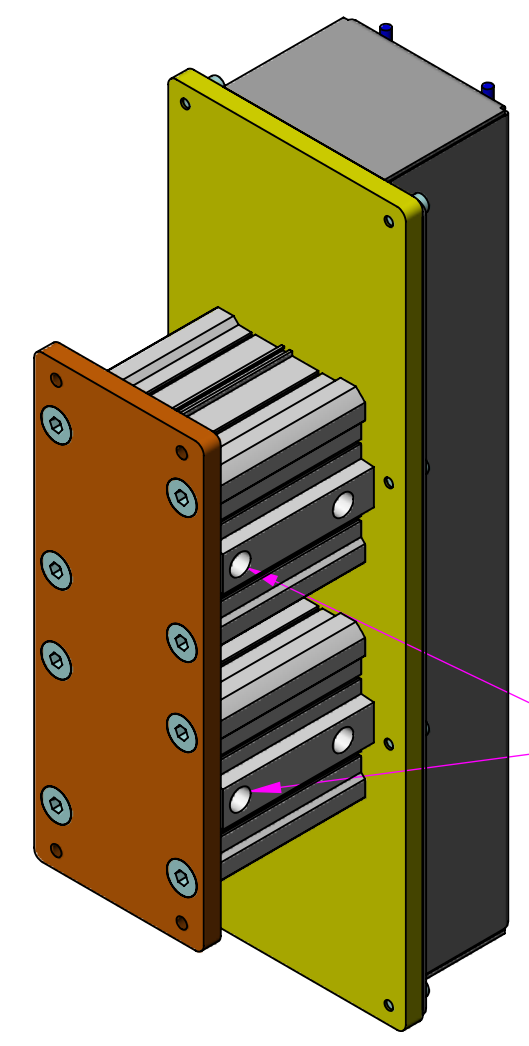

PNEUMATIC CYLINDERS 3/8" PORTS
100MM BORE X 50MM STROKE
PLUMBED BY OTHERS, AIR SUPPLY
MUST BE CLEAN, DRY, COMPRESSED
AIR REGULATED TO 85 PSI. MIN.

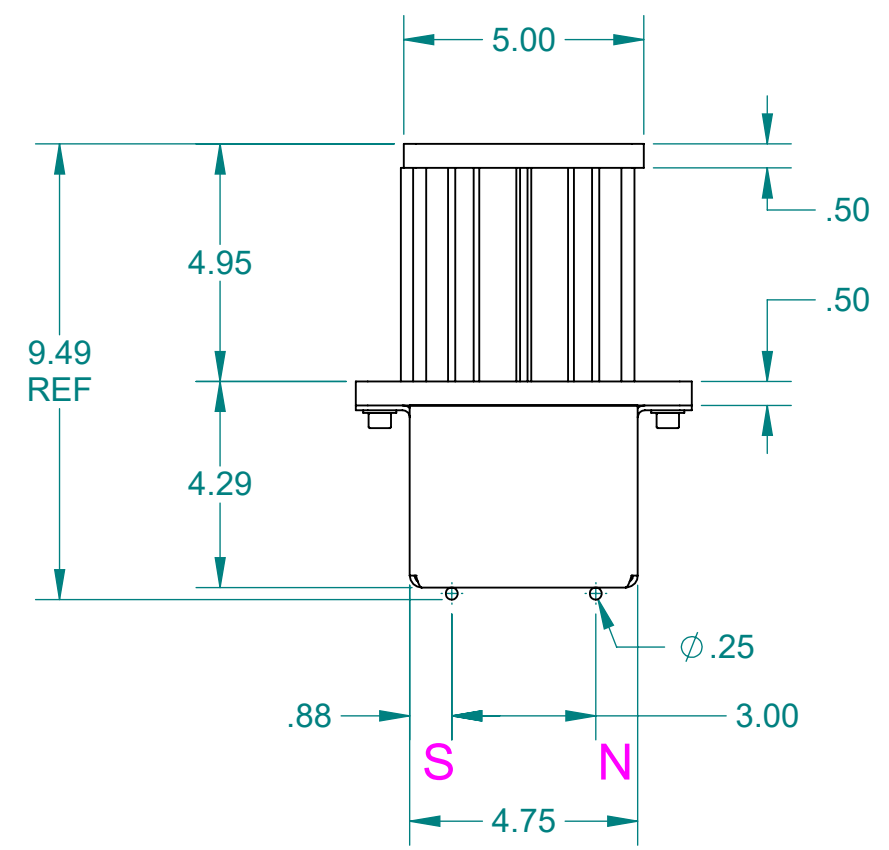
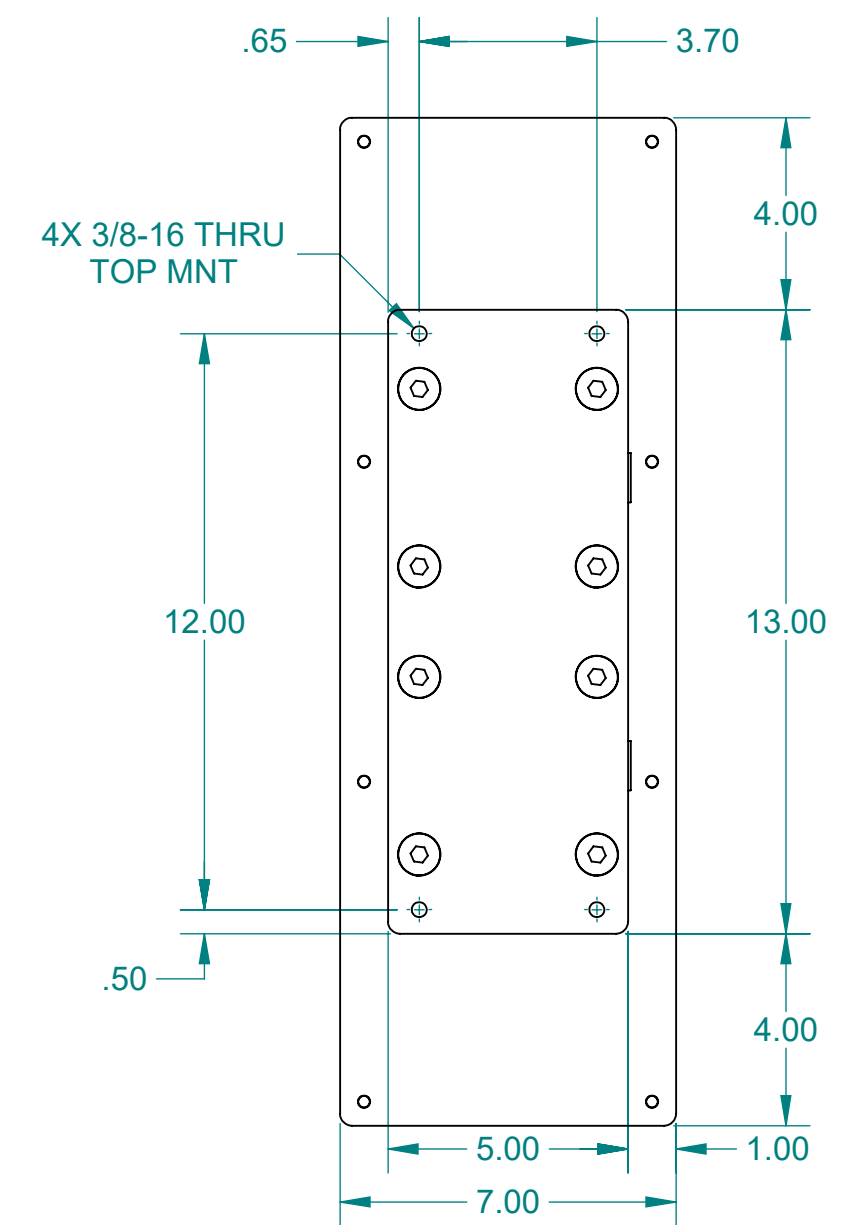
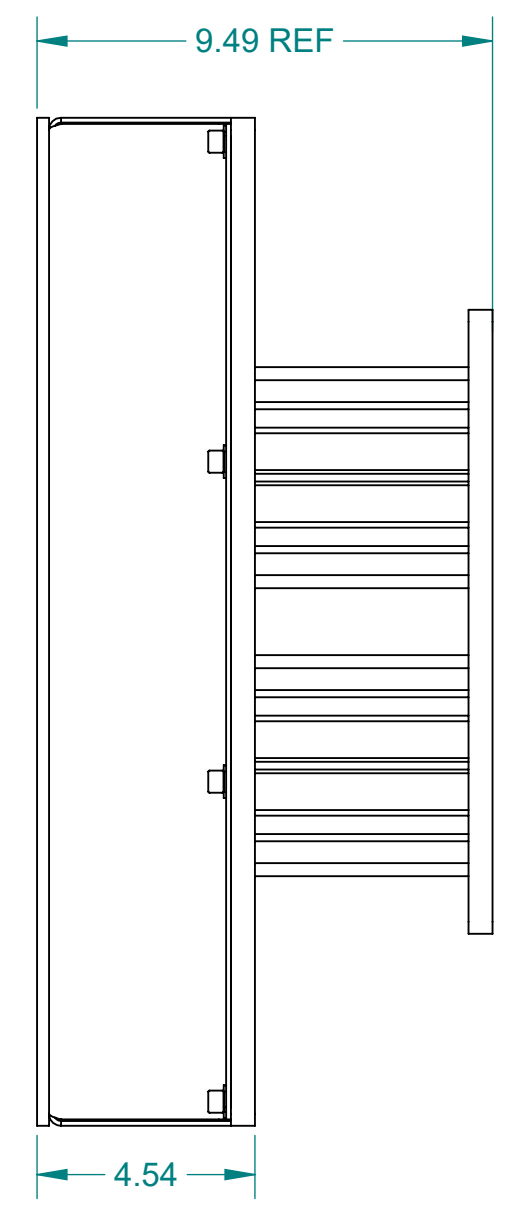
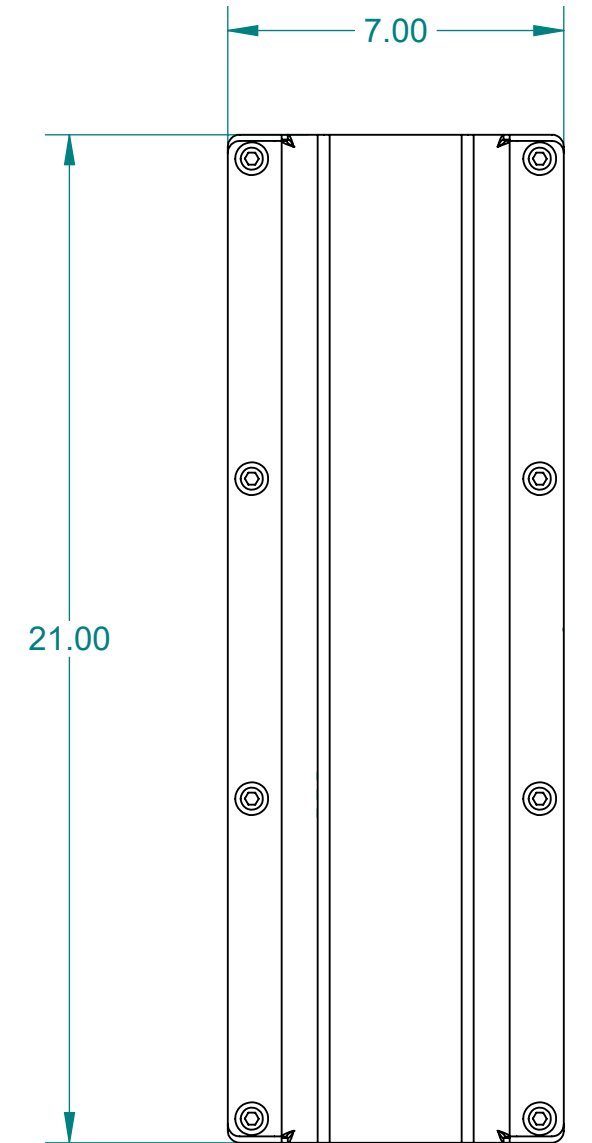
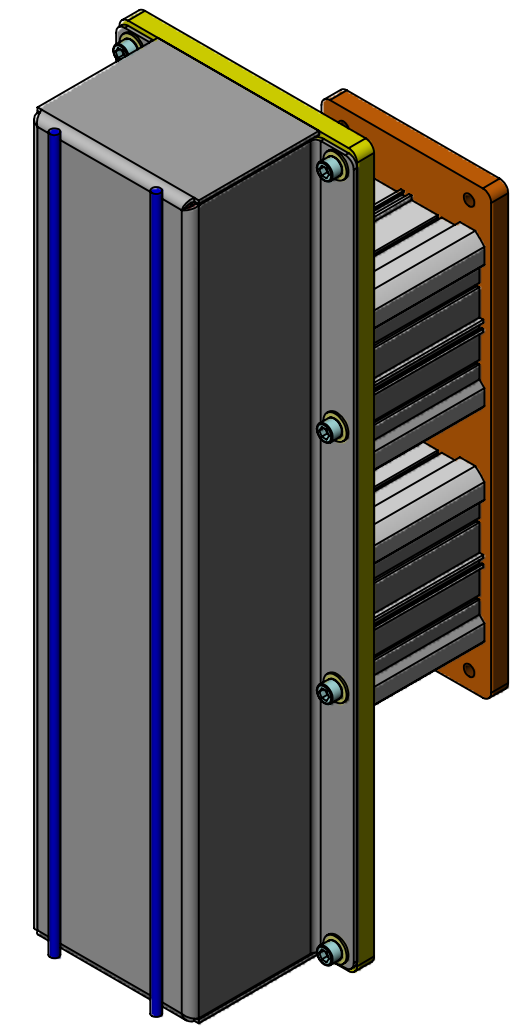

180°F MAX OPERATION TEMP
CUSTOMARY GRADE

APPROXIMATE WEIGHT: 74 LBS

ALL DIMENSIONS ARE IN INCHES EXCEPT AS NOTED. C SIZE - SHEET 1 OF 1

TOLERANCES EXCEPT AS NOTED DECIMAL .00" = ±.030" ANGULAR ±1° .000" = ±.015"		RELEASED DATE J.MOSLEY DATE 11-1-07	R & D SCALE SHOWN	DESCRIPTION PNEUMATIC SHEET FANNER X 21.00 LG RARE EARTH WITH 100MM CYL
This drawing and all of the elements thereof, including the design and principles of construction disclosed, is the sole and exclusive property of Industrial Magnetics, Inc. and is being submitted by Industrial Magnetics, Inc. for the limited purpose of assisting the designated recipient to evaluate the services of Industrial Magnetics, Inc. This drawing may not be used for any other purpose, nor may it be copied, reproduced, loaned, transferred, or communicated to any other person, either verbally or in writing, without the written consent of Industrial Magnetics, Inc.			INDUSTRIAL MAGNETICS, INC. 01385 M-75 SOUTH BOYNE CITY, MI 49712-9689 WWW.MAGNETICS.COM • (231) 582-3100	
PART NO. ARF21		DRAWING NO. 55488		